

Aluminium extension arms KA-21

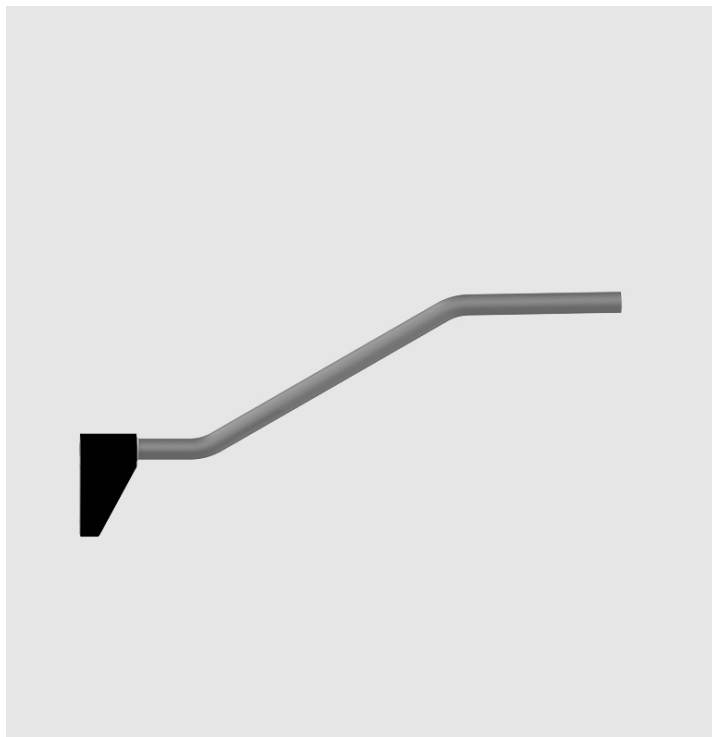

Anodising: 10 colours, each with possibility of chemical brightening

Finish: grinded, anodised aluminium

Packing: sleeve material



Code	Symbol	Net weight	Approximate unit volume	Luminaire mounting diameter
478210/C45/C35	KA-21	5,3kg	0,03m ³	ø60x50-200mm

