

# Aluminium extension arms WR-21/1/1,5/0

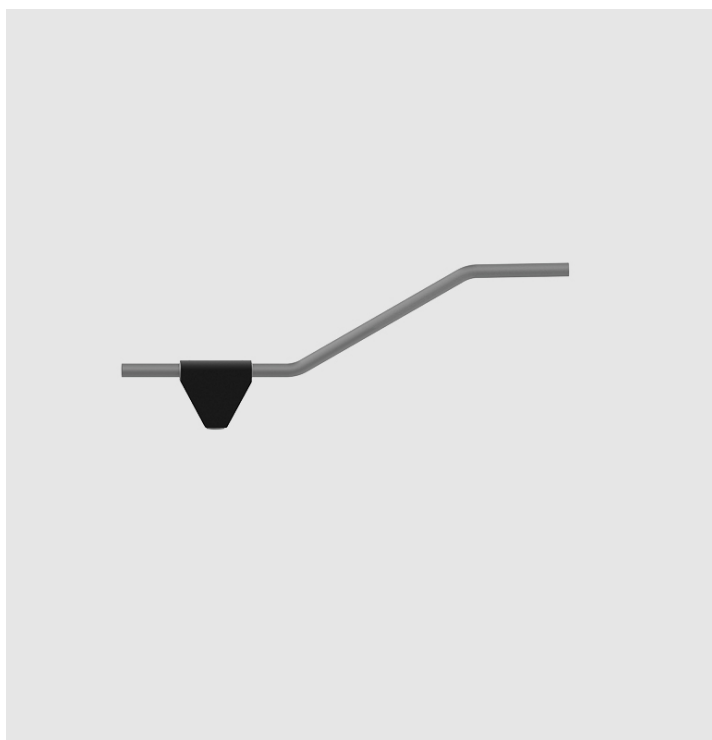

**Anodising:** 10 colours, each with possibility of chemical brightening

**Finish:** grinded, anodised aluminium

**Packing:** sleeve material

**CE certificate :** valid for use on poles manufactured by ROSA company

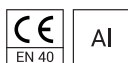

Code	Symbol	Purpose	Number of arms	Extension arm effective projected area	Approximate unit volume	Luminaire mounting diameter	Weight
472211/C45/C35	WR-21/1/1,5/0	–	1	0,18m <sup>2</sup>	0,075m <sup>3</sup>	ø60x50-200mm	7,2kg

